

D

Diaphragm chuck
QUICK JAW CHANGE SYSTEMS

- Clamping jaws
- Closed center rotating cylinder
- Installation

Jaws Type A

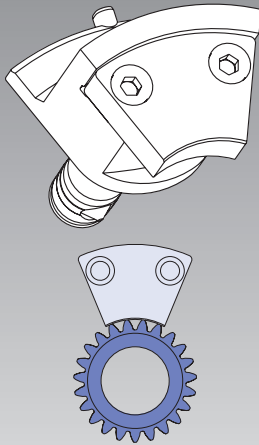

External clamping

Jaws Type B

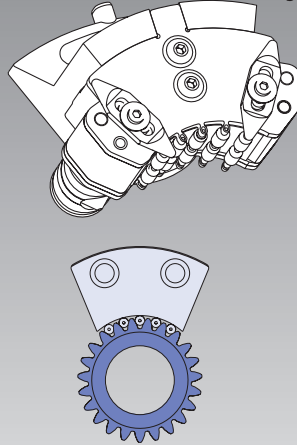

Pitchline clamping with roller cage

Jaws Type C

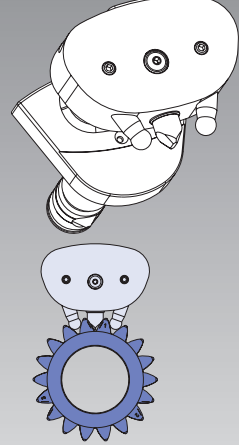

Pitchline clamping with clamping pin

D-KOMBI®

Radial-axial clamping
QUICK JAW CHANGE SYSTEMS

- Clamping jaws
- Rotating double piston cylinder
- Installation

Jaws Type A

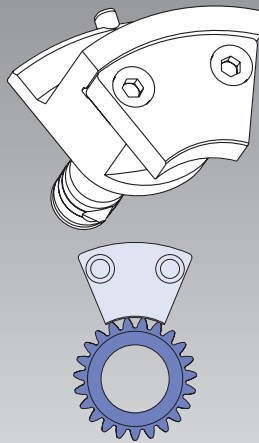

External clamping

Jaws Type B

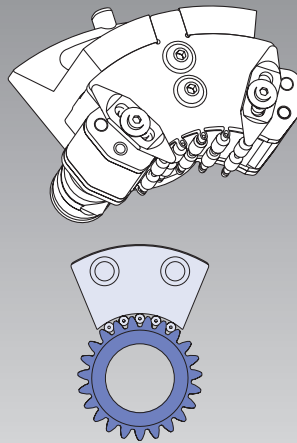

Pitchline clamping with roller cage

Jaws Type C

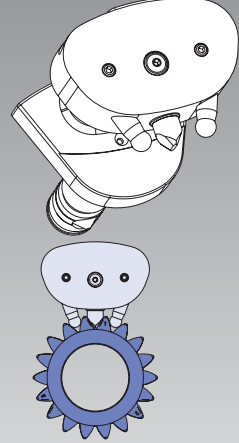

Pitchline clamping with clamping pin

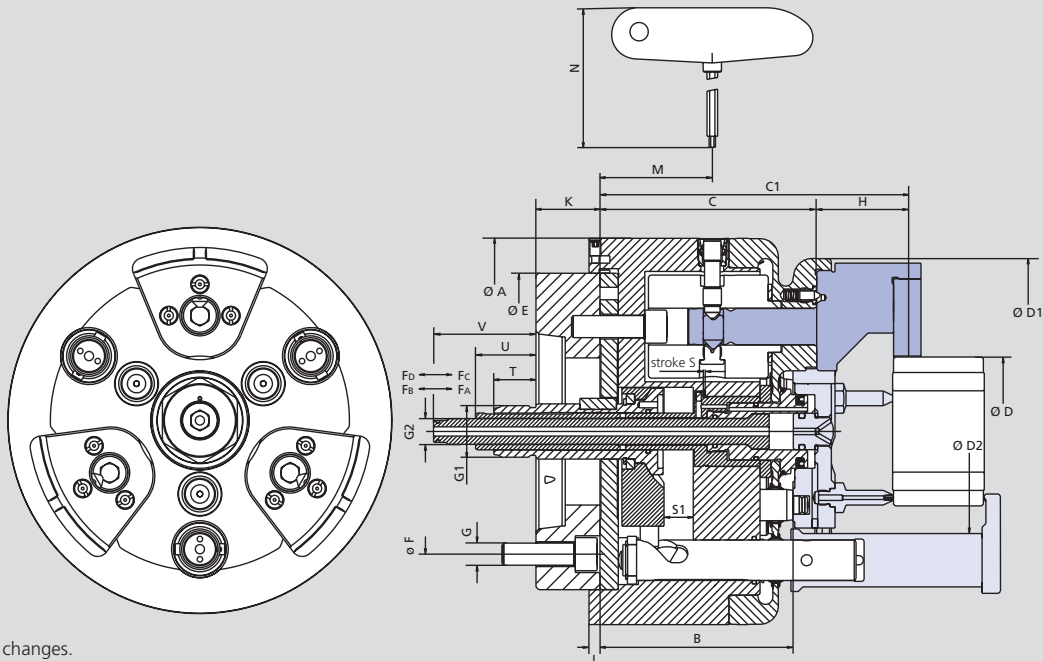

Subject to technical changes.
For more detailed information please ask for customer drawing.

SMW-AUTOBLOK Type			D-210 KOMBI		D-260 KOMBI		D-315 KOMBI		D-400 KOMBI	
Mounting	Size		A5	A6	A6	A8	A8	A8	A8	A11
	A	mm	210		260		315		400	
	B	mm	105.5		111		116		123	
	C	mm	118.5		130		130		136	
	C1	mm	170.5		187		192		-	
Clamping range without fingers	D	mm	20-175		40-220		60-275		126-350	
	D1	mm	188		227		275		354	
Clamping range with fingers	D2	mm	111		153		203		268	
	E	mm	172		225		275		350	
	F	mm	104.8	133.4	133.4	171.4	171.4	171.4	171.4	235
	G		M10	M12	M12	M16	M16	M16	M16	M20
	G1		M28 x 1.5		M28 x 1.5		M28 x 1.5		M28 x 1.5	
	G2		M14 x 1.0		M14 x 1.0		M14 x 1.0		M14 x 1.0	
Jaw height	H	mm	52		62		64		-	
	J	mm	6		6		6		6	
	K	mm	40		48		48		50	
	M	mm	61.4		61.9		61.9		66.5	
	N	mm	185		185		185		185	
Piston stroke	S	mm	1.0		1.5		1.5		1.5	
Axial stroke swing clamps	S1	mm	16		16		16		16	
	T	mm	18		10		10		8	
	U	mm	28		20		20		18	
	V	mm	51		43		43		41	
Jaw stroke at distance H		mm	1.0		1.1		1.2		0.87	
Draw pull min./max. *	F_D	kN	0-25		0-25		0-25		0-25	
Draw push for chuck open	F_C	kN	20		20		20		20	
Draw pull swing clamps max.	F_B	kN	6		9		9		18	
Draw push swing clamps open	F_A	kN	2		2		2		2	
Moment of inertia		kg·m ²	0.16		0.45		0.75		2.26	
Weight without top tooling		kg	30		44		60		109	
Recommended actuating cylinder	Type		ZHVD-DFR		ZHVD-DFR		ZHVD-DFR		ZHVD-DFR	

* Additional draw pull to the diaphragme force actuated by the actuating cylinder

Advice: The max. allowed speed for the application is permanently marked on the corresponding top jaws and must not be exceeded.

Important: Never rotate the chuck without inserted jaws, otherwise the centrifugal force compensation mechanism will get damaged.