

Hydraulic long-stroke vise

- Top jaws
- Connecting cables LPS 4.0

### SLX-125-335 Top jaw SinterGrip

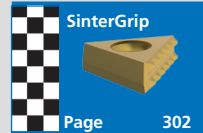
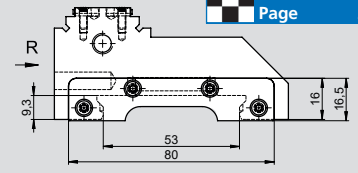
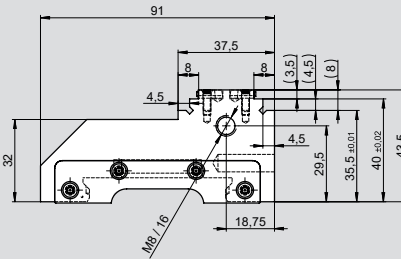
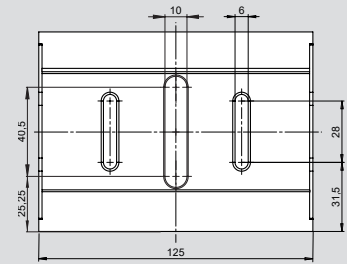
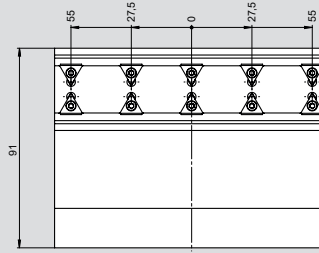
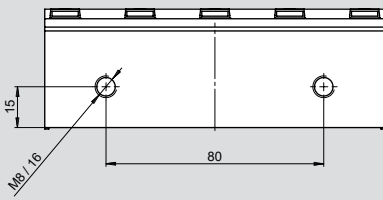
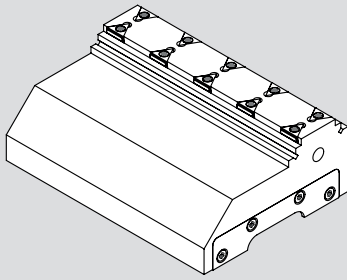

Type	Id. No.	max. total clamping force	Clamping range A/B with SinterGrip	Clamping range A/B smooth
SLX-125-335	461521	75 kN	14,5-223,5 / 123-232 mm	9-118 / 116-225 mm

### SLX-125-335-H45 Soft top jaw

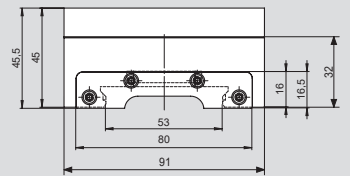
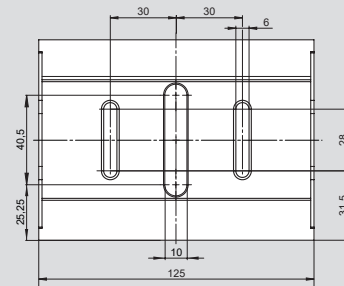
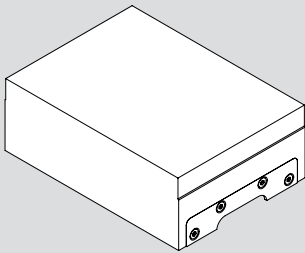

Type	Id. No.	max. total clamping force	min. jaw height	Weight
SLX-125-335-H45	461523	75 kN	32 mm	3,5 kg

### SLX-125-335-H65 Soft top jaw high

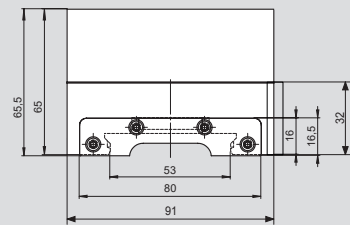
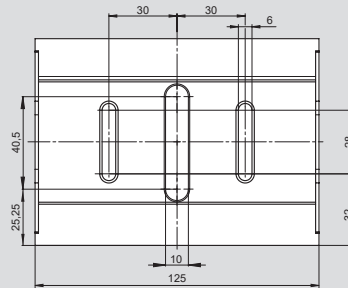
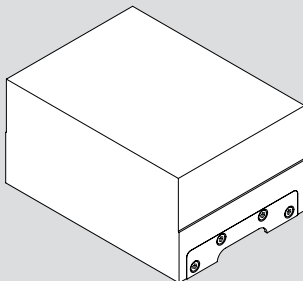

Type	Id. No.	max. total clamping force	min. jaw height	Weight
SLX-125-335-H65	461525	75 kN	32 mm	5,2 kg

Cable* for LPS 4.0 80 IO	Length	Id. No.
Connecting cable with straight plug M12 x 1 5-pole	5 m	208244
	10 m	208245
	15 m	208246
Connecting cable with angled M12 x 1 5-pole	5 m	208247
	10 m	208248
	15 m	208249

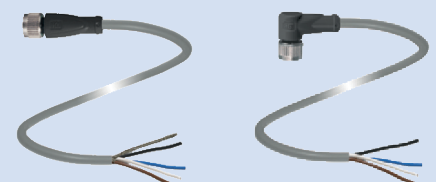

\* Shielded PUR cable, 1 side cable end, 1 side with socket M12 x 1, machined and gold-plated contacts.

Integration example with inductive coupling system

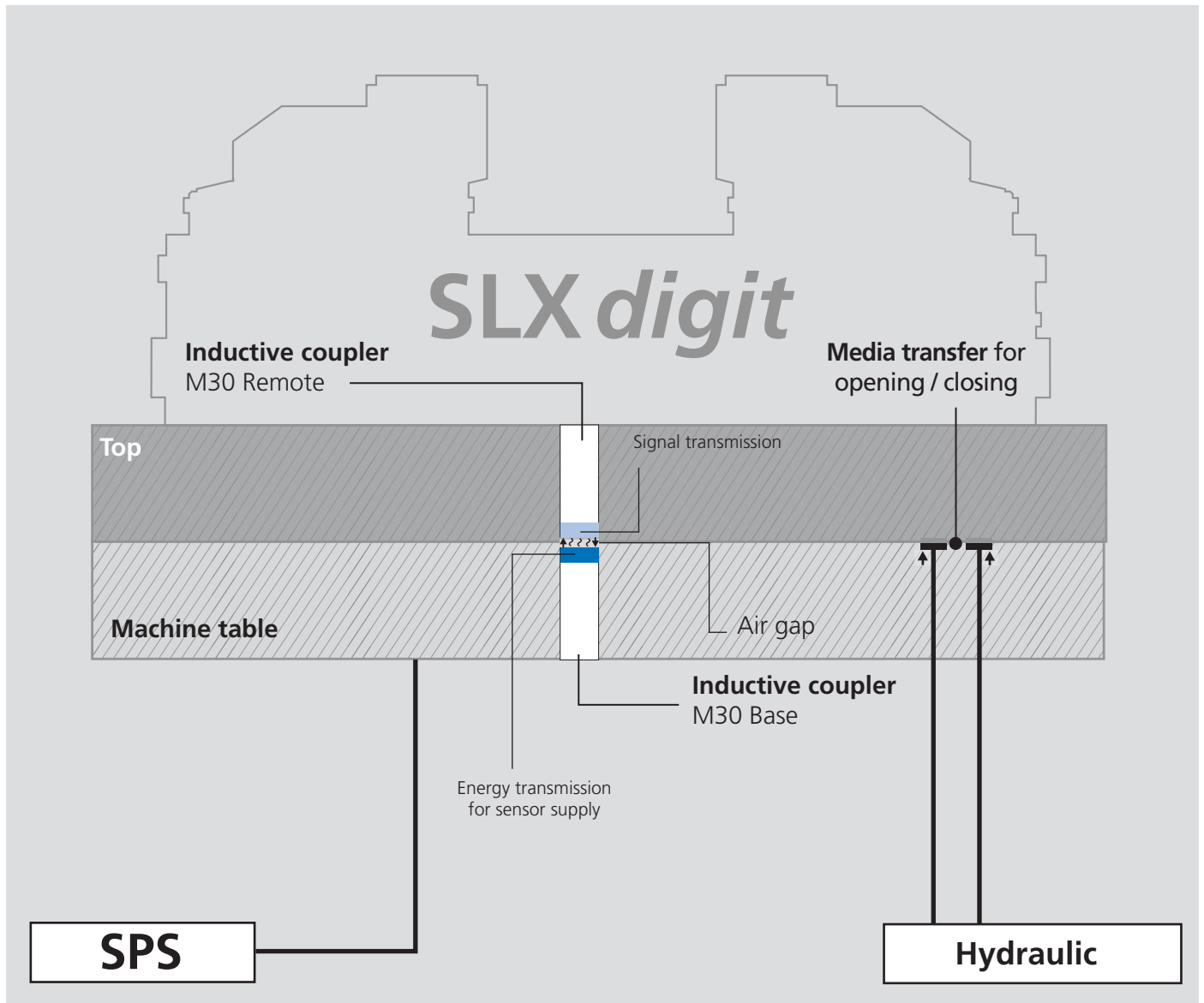

Inductive coupling system:  
further information at [www.smw-electronics.de](http://www.smw-electronics.de)